

TECHNICAL DATA (007A-250X / 007A-500X)

- Weight: 100-150 kg
- Voltage: 400 V, 3-phase, 50 Hz, if the drive 400 V, 1-phase, 50 Hz
- Connected load: 0,75 kW

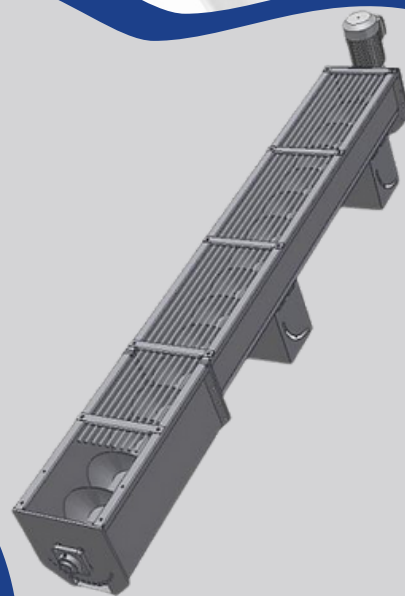

FF SCREW CONVEYOR

“

The Screw conveyor is a hygienic solution for the food industry. The conveyors are available in two sizes. Length, stand, and hoppers can be adjusted on a case-by-case basis.

The screw conveyor is made of stainless steel and food proven plastics. Ask for special solutions like a perforated base or water tank.

Standard diameters: 250 or 400 mm

Length: approx. 1-6 meters, in the step of 250 mm

”